

 ADAMS RITE MANUFACTURING COMPANY
260 SANTA FE STREET, POMONA CA 91767

 ADAMS RITE EUROPE LIMITED
MORETON INDUSTRIAL ESTATE, LONDON ROAD,
SWANLEY, KENT, BR8 8TZ +44(0)1322 668024

 CERTIFICATE OF CONFORMITY
No. 1211-CPD-AB0011
8460-02 RADIUS STRIKE

REMOVE THE TWO MACHINE SCREWS LOCATED AT THE REAR OF THE CASE AND REMOVE THE RETAINING PLATE.

REMOVE THE DEADLATCH AND AUXILIARY BOLT SPRINGS.

DISENGAGE THE DEADLATCH HEEL FROM FROM ITS SLOT AND PUSH THE LATCH ASSEMBLY ALONG ITS RUNNERS AND OUT OF THE CASE.

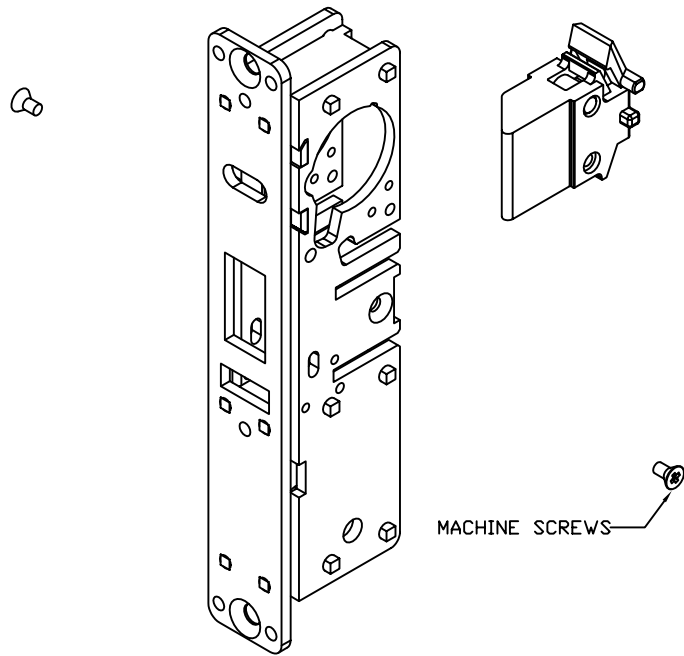

DEADLATCH SPRING

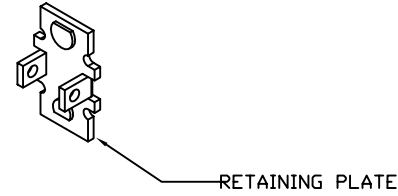

RETAINING PLATE

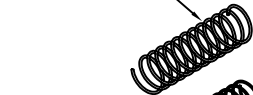

AUXILIARY BOLT SPRING

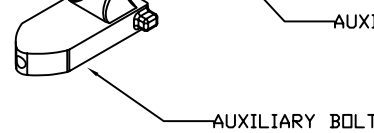

AUXILIARY BOLT

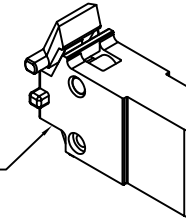

LATCHBOLT ASSEMBLY

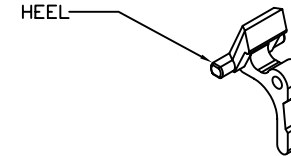

HEEL

TURN THE LATCHBOLT ASSEMBLY SO THAT THE LATCH IS FACING DOWN.

REMOVE HEEL PIVOT PIN FROM THE LATCHBOLT ASSEMBLY AND CAREFULLY REMOVE THE HEEL.

WATCH OUT FOR THE SMALL DEADLATCH SPRING THAT IS LOCATED BENEATH THE HEEL AND MAKE SURE IT IS SITTING VERTICALLY.

TURN THE LATCHBOLT THROUGH 180 DEGREES TO THE OPPOSITE HAND AND INSERT THE HEEL INTO POSITION.

INSERT THE HEEL PIVOT PIN INTO POSITION AND CHECK THE DEADLATCH SPRING IS CORRECTLY LOCATED.

REINSERT THE LATCHBOLT ASSEMBLY INTO THE CASE RELOCATING THE AUXILIARY BOLT AND THE APPROPRIATE SPRINGS.

REFIT THE RETAINING PLATE AND SECURELY FASTEN WITH THE MACHINE SCREWS.

CHECK THE OPERATION OF THE LATCHBOLT ASSEMBLY AND THE DEADLATCHING FACILITY BY DEPRESSING THE AUXILIARY BOLT AND PUSHING THE LATCH. THE LATCH SHOULD NOT MOVE, IF IT DOES THE DEADLATCH SPRING IS NOT LOCATED PROPERLY; REMOVE THE LATCHBOLT ASSEMBLY AND REPOSITION.

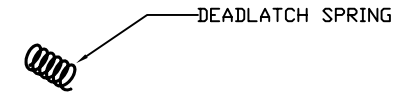

DEADLATCH SPRING

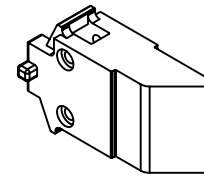

HEEL PIVOT PIN

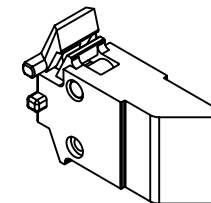

ADAMS RITE MANUFACTURING COMPANY

260 SANTA FE STREET, POMONA CA 91767



ADAMS RITE EUROPE LIMITED
 MORETON INDUSTRIAL ESTATE, LONDON ROAD,
 SWANLEY, KENT. BR8 8TZ +44(0)1322 668024



CERTIFICATE OF CONFORMITY
 No. 1211-CPD-AB0011

REHANDING THE DEADLATCH