

Armlock® 261 & 262

Direct-Pull Magnets

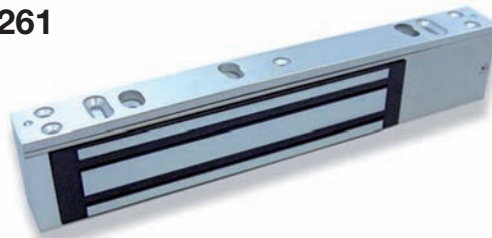

The Adams Rite Door magnet range are direct pull magnets that are used as part of an access control system for electric locking applications.

261**262**

Key Benefits

- Suitable for use on aluminium, timber and steel doors
- Compact case size & clean aesthetics
- Maintains a magnetic holding force of at least 250kg (550lbs)
- Strong durability & low maintenance
- Fit any aluminium, timber or steel door
- CE marked
- Has a security pin feature to help prevent unauthorised brackets removal of the magnet from the door frame fixing plate
- Available for outward and inward opening door applications
- User selectable dual voltage - 12 or 24vDC
- Also available as a double magnet model
- Surface or mortice version
- Monitoring available (Hall Effect)
- Built in voltage spike suppressor

Related Hardware

'L' and 'Z' Brackets ~ Armature Housing ~ 4591M & 999M Monitored Paddle Handle & Exit Device ~ Switching Accessories ~ RiteKey Keypad ~ Push-to-Exit Button ~ Power Supply Unit

Note: For out of hours security specify the Sentinel 6 Deadlock in conjunction with the direct-pull magnet.

Dimensions

Armlock® 261-005

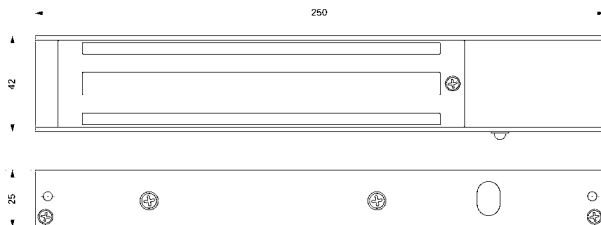

Armlock® 262-005

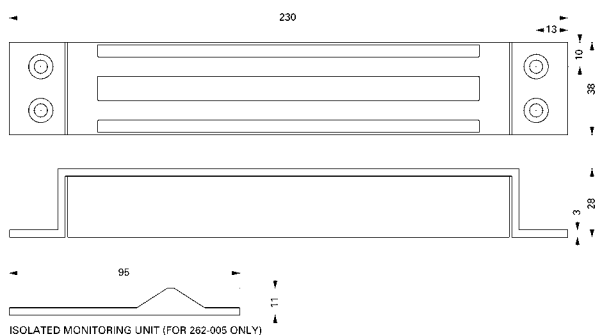

Armature for Armlock 260® Series Magnets

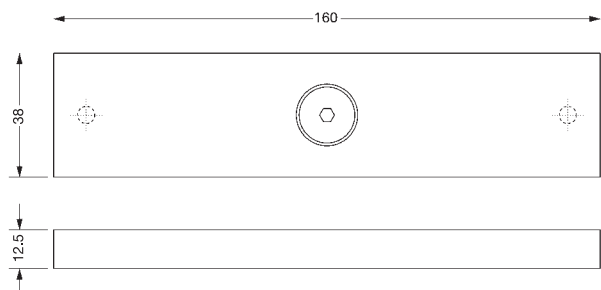

Specifications

- Single Magnet:** 25mm x 250mm x 42mm (261 models).
28mm x 230mm x 38mm (262 model).
- Double Magnet:** 25mm x 500mm x 42mm (261 models only).
- Armature:** 11.3mm x 160mm x 36mm (2 no. for double magnet).
- Nominal Holding Force:** 250kg (550lbs).
- Supply Voltage:** 12 or 24vDC ($\pm 15\%$). Dual coil.
- Nominal Current:** 480mA @ 12vDC, 240mA @ 24vDC.
Built-in voltage spike suppressor.
- Monitoring:** Relay dry contact with LED.
Integral on 261 models, compact isolated unit on 262-005.
- Door Gap:** Maximum 3mm (1/8").
- 261 Positioning:** Outward opening - surface mounted to door frame header. Inward opening - door frame header using 'L' & 'Z' brackets.
- 262 Positioning:** Mortice mounted for single action swinging or sliding door applications (not to be used as a shearlock).
- Magnet Housing:** Brushed satin aluminium.
- Note:** To achieve immediate release, it is important that the release switch breaks the circuit on the positive supply to the magnet.

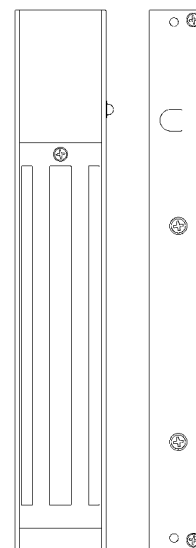

Ordering Codes

- 261-000** Surface mounted single direct-pull magnet, 12/24vDC, non-monitored, suitable for timber or metal door applications.
- 261-200** Surface mounted double direct-pull magnet, 12/24vDC, non-monitored, suitable for timber or metal door applications.
- 261-005** Surface mounted single direct-pull magnet, 12/24vDC, monitored, suitable for timber or metal door applications.
- 261-205** Surface mounted double direct-pull magnet, 12/24vDC, monitored, suitable for timber or metal door applications.
- 262-005** Mortice mounted single direct-pull magnet, 12/24vDC, monitored, complete with armature fixings for timber and metal doors.
- 268-600** Armlock® 260/280 Series glass armature bracket.

Parts

- 261-300** Spare armature plate only for 260 series.
- 261-015** Surface mounted magnets & armature fixings only for 260 series.