

MS[®]1850SNSI

Maximum Security Deadlock

The Adams Rite MS[®] 1850SNSI Maximum Security Deadlock is identical in operation to the MS[®] 1850S series Deadlock and is for use in hollow, metal or wooden doors.



Key Benefits

- Available for use on timber and steel doors.
- Interchange without stile modification with the 4720ANSI deadlatch
- Longer fixing tab positions to enable greater fixing security.

Related Hardware

Round Cylinders ~ MS[®]4043 Cylinder Guard ~ Round Thumbturns
Trim Strikes ~ 4015 Threshold Bolt

Note: Cylinders, thumbturns and faceplates not supplied as standard; order separately.

Note: 628 denotes Satin Anodised Finish-substitute 628 with 313 for Bronze, or 335 for Black.

Dimensions

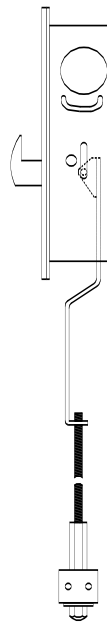
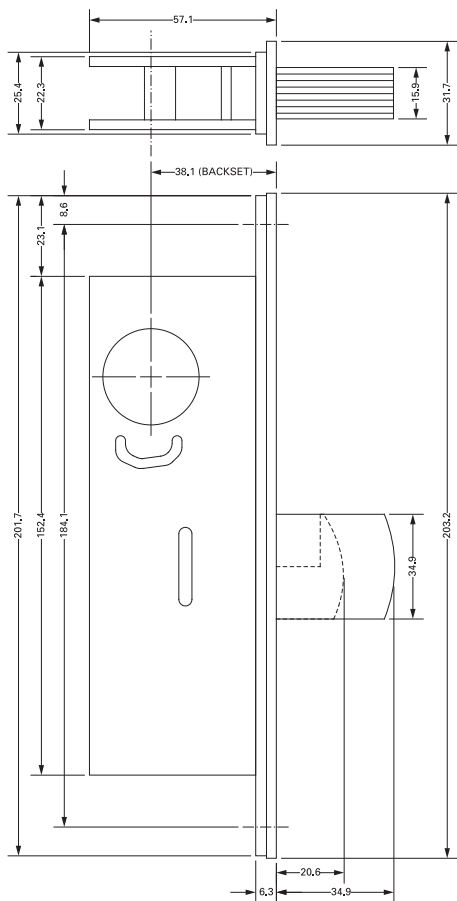

**Optional 4015-18
Threshold Bolt
(for hollow metal
doors)**

Specifications

Overall Case Size:	201.7mm x 31.7mm x 57.1mm.
Case:	Steel with corrosion-resistant plating.
Backset:	38.1mm (1 1/2").
Lock Bolt:	34.9mm x 15.9mm. 8 Ply Laminated Steel with patented Alumina-Ceramic Anti-Saw Core.
Bolt Throw:	34.9mm (Barbolt), 20.6mm (Hookbolt).
Mechanism:	Carbon Steel Actuating Mechanism.
Cylinder:	Any standard 29.4mm (1 5/32") Mortise Cylinder or Thumbturn with MS® cam.
Operation:	360° turn of key or thumbturn. Key only removable when bolt is positively locked or unlocked.
Door Gap:	Maximum 3mm.
Two Point Locking:	Specify 4015 Threshold Bolt.
Forend:	Steel, with aluminium faceplate.

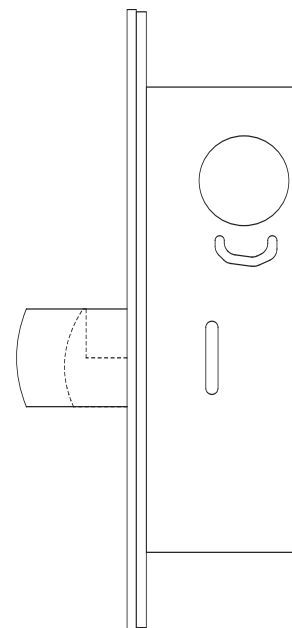
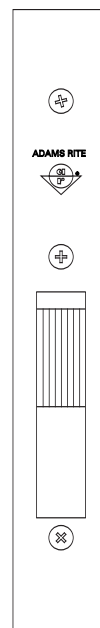

Ordering Codes

Lock Bodies

1850-411	38.1mm (1 1/2") Backset Barbolt ANSI Deadlock
1850-451	38.1mm (1 1/2") Backset Hookbolt ANSI Deadlock

Faceplates

24-1850-011-628	MS®1850 ANSI Faceplate Flat Bar Lock SAA Finish
24-1850-051-628	MS®1850 ANSI Faceplate Flat Hook Lock SAA Finish
24-1850-111-628	MS®1850 ANSI Faceplate Radius Bar Lock SAA Finish
24-1850-151-628	MS®1850 ANSI Faceplate Radius Hook Lock SAA Finish